

## Cartridge Mechanical Seals

LYGU0

● **Operational Conditions:**

Temperature: -20℃+220℃

Pressure: ≤2.5MPa

Speed: ≤16m/s

● **Materials:**

Stationary Ring: Q1,A,V1

Rotary Ring: A,Q1,U2

Secondary Seal: E,V,Aflas,kalrez

Spring and Metal Parts: F,G,M

● **Applications: Clean water,sewage water,oil and other moderately corrosive fluids.**

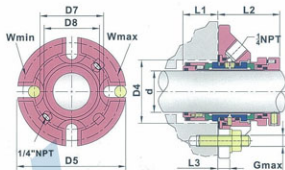
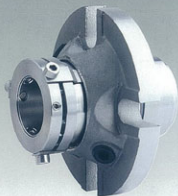

规格/Size (公制/Metric)	D5	D7	D8	L3	MIN	D4	MAX	MIN	W	MAX	M	L1	L2
24	104.8	54.0	49.2	13.2	40.0	46.0	67.0	90.5	12	32.5	52.4		
25	104.8	54.0	49.2	13.2	41.0	49.0	67.0	90.5	12	32.5	52.4		
28	108.0	57.2	52.4	13.2	44.0	52.3	70.3	93.6	12	32.5	52.4		
30	111.0	60.4	55.6	13.2	46.0	55.5	73.5	96.8	12	32.5	52.4		
32	111.0	60.4	55.6	13.2	48.0	55.5	73.5	96.8	12	32.5	52.4		
33	111.0	60.4	55.6	13.2	49.0	55.5	73.5	96.8	12	32.5	52.4		
35	111.0	63.5	58.8	13.2	51.0	57.5	76.6	96.8	12	32.5	54.0		
38	127.0	71.5	65.0	16.4	57.2	60.3	85.7	114.3	12	33.3	54.0		
40	127.0	71.5	65.0	16.4	58.0	60.4	85.7	114.3	12	33.3	54.0		
43	127.0	71.5	65.0	16.4	61.0	63.5	85.7	114.3	12	33.3	54.0		
45	139.7	81.0	71.4	16.4	63.5	69.9	95.3	127.0	12	33.3	54.0		
48	139.7	81.0	71.4	16.4	66.7	73.0	95.3	127.0	12	33.3	54.0		
50	139.7	81.0	71.4	16.4	68.0	73.0	95.3	127.0	12	33.3	54.0		
53	152.4	90.5	77.8	16.4	71.0	76.0	104.8	139.7	12	35.0	54.0		
55	152.4	90.5	77.8	16.4	74.0	79.4	104.8	139.7	12	35.0	54.0		
58	165.1	96.8	84.1	16.4	76.2	82.5	114.3	149.2	16	35.0	54.0		
60	165.1	96.8	84.1	16.4	79.4	85.7	114.3	149.2	16	35.0	54.0		
63	177.8	109.5	96.8	19.6	85.8	92.1	127.0	160.3	16	38.1	60.3		
65	177.8	109.5	96.8	19.6	88.9	95.3	127.0	160.3	16	38.1	60.3		
68	177.8	109.5	96.8	19.6	92.1	98.4	127.0	160.3	16	38.1	60.3		
70	177.8	109.5	96.8	19.6	92.1	98.4	127.0	160.3	16	38.1	60.3		
75	190.5	125.4	108.0	19.6	98.5	108.0	142.9	173.0	16	38.1	60.3		
80	190.5	125.4	108.0	19.6	101.6	111.1	142.9	173.0	16	38.1	60.3		
85	203.2	135.0	117.5	19.6	108.0	117.5	155.6	182.5	20	38.1	60.3		
90	215.9	150.8	127.0	19.6	114.3	127.0	171.5	195.2	20	38.1	60.3		
95	215.9	150.8	127.0	19.6	117.5	130.2	171.5	195.2	20	38.1	60.3		
100	228.6	168.3	136.5	19.6	123.9	139.7	189.0	208.0	20	38.1	60.3		
105	228.6	168.3	136.5	19.6	130.1	149.2	189.0	208.0	20	38.1	60.3		
110	241.3	177.8	146.2	19.6	136.5	158.8	198.4	220.6	20	38.1	60.3		
115	254.0	186.6	155.8	19.6	142.9	168.3	211.1	230.2	23	38.1	60.3		
120	254.0	186.6	155.8	19.6	142.9	168.3	211.1	230.2	23	38.1	60.3		
125	254.0	186.6	155.8	19.6	149.2	168.3	211.1	230.2	23	38.1	60.3		